

1/9

サービス パーツ リスト

BM21-27CTBF-50

HYD. Motol - Inner Parts List -

MST-700E #70876 ~701197

MST-800E #2501 ~3572

ダイキン工業株式会社

作成 平成 8 年 5 月

HYD. MOTOR
BM21-27CTBF-50

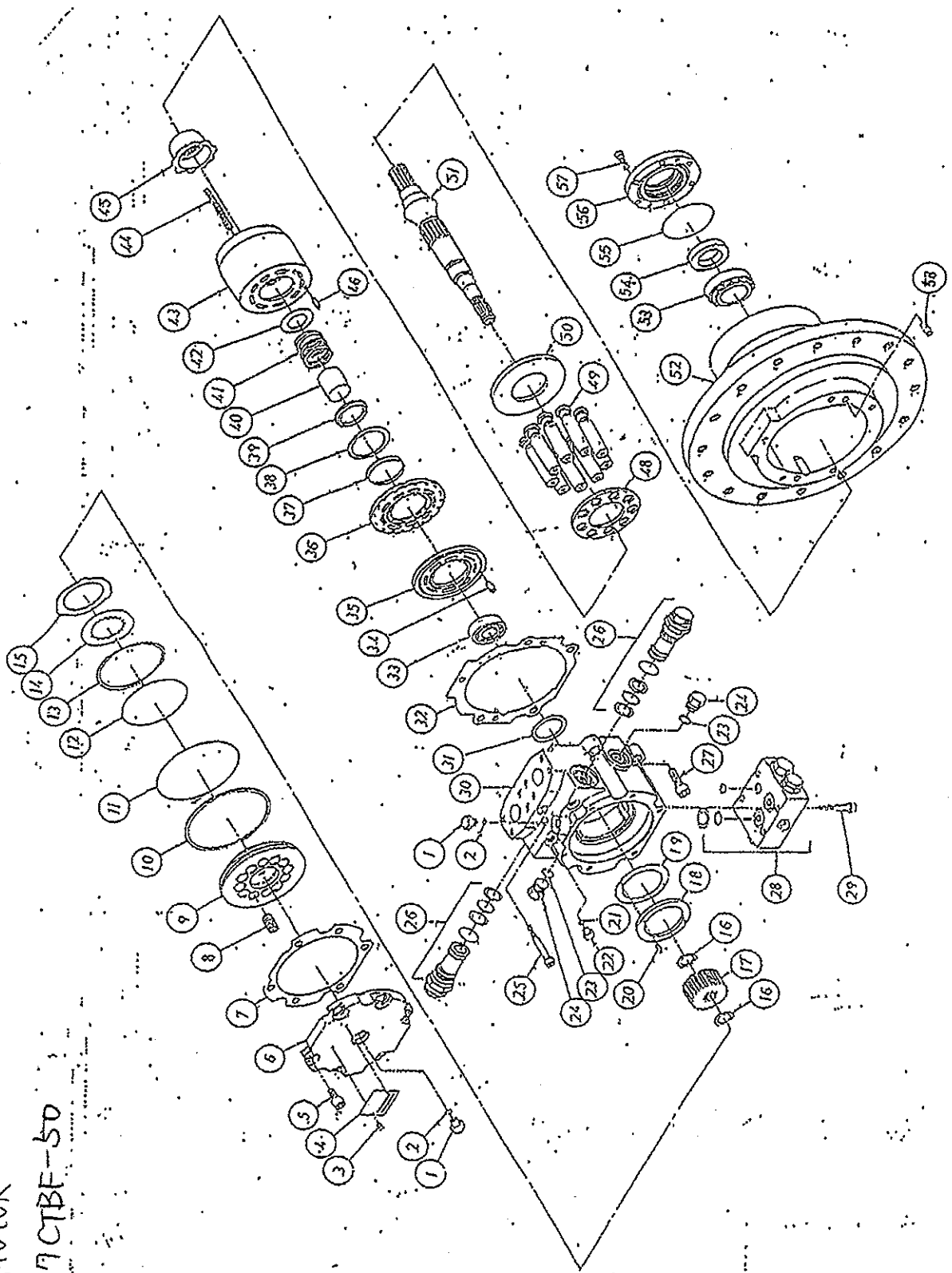

2/9

No.	Description	Part Number	Qty(per 1 unit)	Note
1	Plug	9005101-5000	2	
2	O-ring	9004201-3100	2	
3	Rivet	SB1040311	2	
4				
5	Screw (Socket head)	JISB1176 M10x20L	6	
6	Brake cover	SB1020313	1	
7	Gasket	SB1030486	1	
8	Spring	SB1040678	12	
9	Brake piston	SB1020312	1	
10	Backup ring	9006100-2470	1	
11	O-ring	9004101-2470	1	
12	O-ring	9004101-2390	1	
13	Backup ring	SB1041032	1	
14	Friction plate	SP409 (FCP00095)	8	
15	Separate plate	SP410 (FCM00061)	9	
16	Retaining ring	FBD024 (JISB2804 C-24)	2	
17	Brake hub	SB1030485	1	
18	Stopper	SB1040679	1	
19	Shim	SB1040680	A/R	
20	Pin (Straight headless)	9004800-1508	2	

Travel Motor Daikin BM21-27CTBF-50

No.	Description	Part Number	Qty(per 1 unit)	Note
21	O-ring	9004201-2500	2	
22	Plug	9005101-4400	2	
23	O-ring	9004201-6200	2	
24	Plug	9005101-8700	2	
25	Screw (Sockethead)	JISB1176 M8x70L	1	
26	Relief valve Ass'y	9803127-5000 (1040262-50)	2	
27	Screw (Sockethead)	JISB1176 M12x35L	4	
28	Flushing valve Ass'y	SB1020314 (SB-369) (1721552-11)	1	
(28-1)	Plug	9005475-0069 (SB9802034)	2	
(28-2)	O-ring	9004201-3700 (9004201-6200)	3	
(28-3)	Spring	SB1041359 (SB9800366)	2	
(28-4)	Washer	SB1041360 (9009625-2901)	2	
(28-5)	Plug	9005101-4400	1	
(28-6)	O-ring	9004201-2500	1	
(28-7)	(Housing)	Not available		
(28-8)	Spool	SB1731152 (SB9800564)	1	
(28-9)	Plug	SB9800367	1	
(28-10)	Shim	SB9800174	A/R	
(28-11)	Spring	SB9801205	1	

Travel Motor Daikin BM21-27CTBF-50

No.	Description	Part Number	Qty(per 1 unit)	Note
(28-12)	Piston	SB1742610 (SB9801206)	1	
(28-13)	O-ring	KP1B011 (JISB2401 1BP11)	1	
(28-14)	O-ring	KP1B022 (JISB2401 1BP22)	2	
(28-15)	Backup ring	SB1040511	2	
29	Screw (Sockethead)	JISB1176 M8x50L	4	
30	(End cap)	Not available		
31	Shlm	SB9210435	A/R	
32	Gasket	SB1020308	1	
33	Cup bearing	4T-1730	1	
	Cone bearing	4T-1780	1	
34	Pin (Straight headless)	9004800-3110	1	
35	Valve plate	SB9210480	1	
36	Bearing plate	SB9210337	1	
36-49	Cylinder block kit	SB9210574 (for Hi-speed) (SB9210578)	1	
50	Thrust plate	SB9210293	1	
51	Shaft	SB1010432	1	
52	(Housing)			
53	Bearing	SP0448 (4T-32008X)	1	
54	Seal rip	SB1040593	1	

Travel Motor Daikin BM21-27CTBF-50

No.	Description	Part Number	Qty(per 1 unit)	Note
55	O-ring	KG1A075 (JISB2401 1AG75)	1	
56	Seal cover	SB1020310	1	
57	Screw (Sockethead)	JISB1176 M6X20L	6	
58	Pin (Straight headless)	9004800-3708	2	

サービス パーツ リスト

BM21 - 27CTBF - 50用

減速機

REDUCTION GEAR
Inner parts list

MST-700E #70876 ~701197

MST-800E #2501 ~3572

ダイキン工業株式会社

作成 平成2年11月

REDUCTION GEAR
BM 21-270TBF-50

819

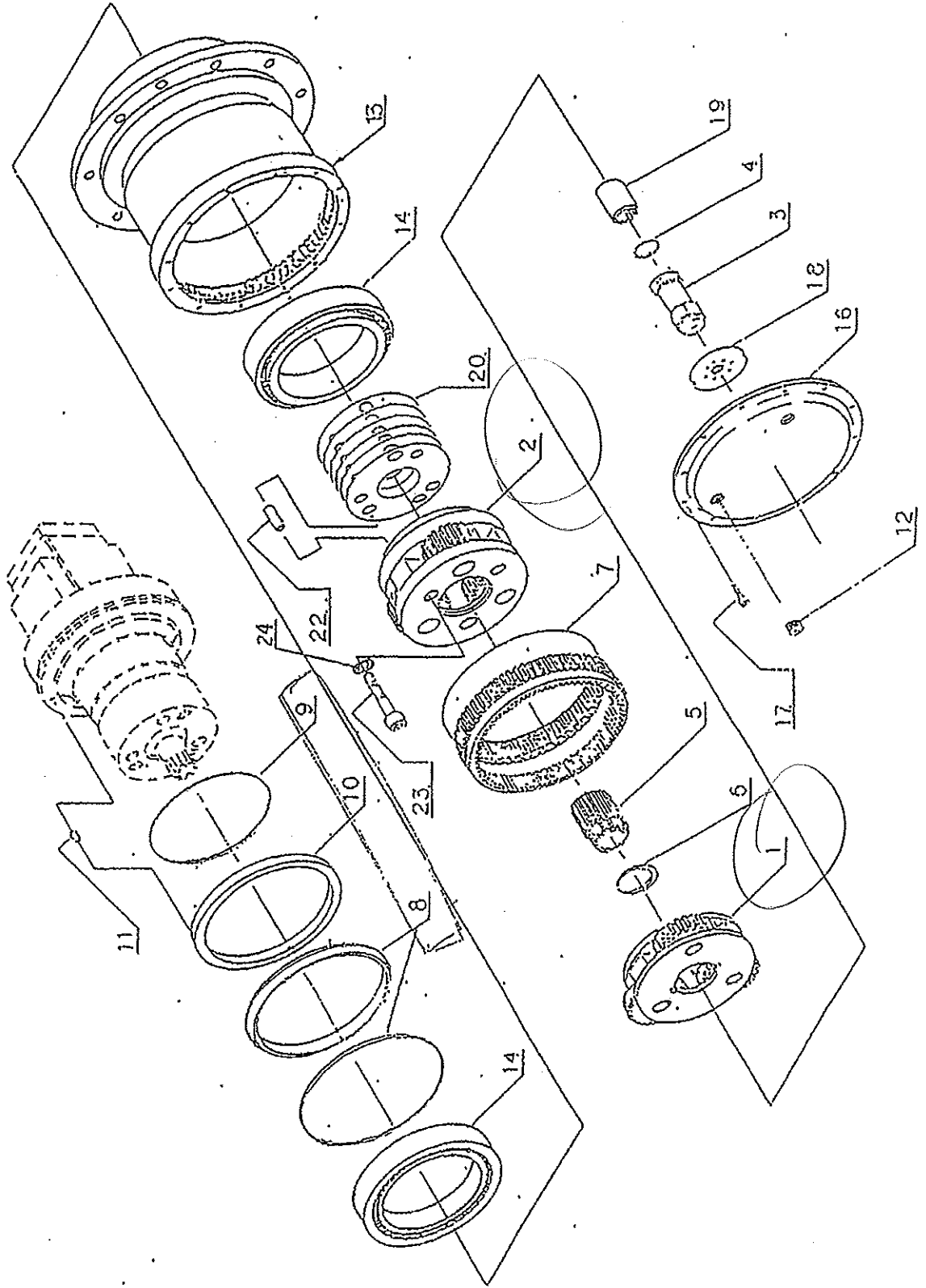

Reduction Gear Daikin BM21-27CTBF-50 (SB487)

No.	Description	Part Number	Qty
1	Holder A Assy	WR65H131A	1
2	Holder B Assy	0321S0280	1
3	Drive Gear	WR65A134A	1
4	Stop Ring	0322S0700	1
5	Sun Gear	WR65H136B	1
6	Stop Ring	WT59C212A	1
7	Ring Gear	0567A3050	1
8	Floating Seal	WT59C214A	1
9	O-Ring	0307S0516	1
10	Seal Collar	0510S0100	1
11	Spring Pin	*No more available	1
12	Plug	WR65A152A	1
13	Housing	0250C0800	1
14	Tapered Roller Bearing	*No more available	2
15	Spring Washer	*No more available	12
16	Cover	0021G0825	12
17	Bolt	WR45A413B	Option
18	Thrust Plate (0.8)	WR45A414B	Option
	Thrust Plate (1.2)	WR45A415B	Option
	Thrust Plate (1.6)	WR45A416B	Option
	Thrust Plate (2.0)		Option
19	Coupling	WR55A511A	1
20	Shim(0.25)	WR65A181A	Option
	Shim(0.3)	WR65A182A	Option
	Shim(0.35)	WR65A183A	Option
	Shim(0.4)	WR65A184A	Option
	Shim(0.45)	WR65A185A	Option
21	Drain Plug Assy	WR65A154A, 155A	4
22	Knock Pin	WR65A128A	3
23	Hexagonal Bolt with hole	0037S2075	3
24	Knock Pin	WR65A137A	4

113170

